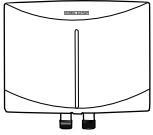

2018 MSRP FOR PLUMBING WHOLESALERS Effective Jan. 1, 2018

MSRP

POINT-OF-USE TANKLESS ELECTRIC WATER HEATERS

Electro-mechanical models.

Mini™ Series				\$199.00
231045	Mini™ 2-1	120 v, 1.8 kW, single phase	Restricted to 0.32 gpm. Ships with 0.5 gpm aerator	
232098	Mini™ 2.5-1	120 v, 2.4 kW, single phase	Ships with 0.5 gpm aerator	
220816	Mini™ 3-1	120 v, 3.0 kW, single phase	Ships with 0.5 gpm aerator	
232099	Mini™ 3.5-1	120 v, 3.5 kW, single phase	Ships with 0.66 gpm aerator	
222039	Mini™ 4-2	240 v 3.5 kW / 208 v 2.6 kW, single phase	Ships with 0.66 gpm aerator	
220817	Mini™ 6-2	240 v 5.7 kW / 208 v 4.3 kW, single phase	Ships with 1.0 gpm aerator	

Thermostatic models, electronically controlled. For one or two taps.

Adding a Stiebel Eltron TLC Assembly to a Mini™-E will meet the requirements of UPC 413.1/ASSE 1070.
See TLC assemblies in Tankless Accessories.

Mini™-E Series				Factory Set Temperature \$299.00 Custom Set Temperature \$329.00
236011	Mini™-E 2-1	120 v, 1.8 kW, single phase	Restricted to 0.40 gpm. Ships with 0.5 gpm aerator	
236135*	Mini™-E 2.5-1	120 v, 2.4 kW, single phase	Ships with 0.5 gpm aerator	
236010	Mini™-E 3-1	120 v, 3.0 kW, single phase	Ships with 0.5 gpm aerator	
236136*	Mini™-E 3.5-1	120 v, 3.5 kW, single phase	Ships with 0.5 gpm aerator	
236009	Mini™-E 4-2	240 v 3.5 kW / 208 v 2.6 kW, single phase	Ships with 0.5 gpm aerator	
236008	Mini™-E 6-2	240 v 5.7 kW / 208 v 4.3 kW, single phase	Ships with (2) 0.5 gpm aerators	

Mini™-E models are factory set for 100°F output.

Custom settings are available at 95, 96, 98, 101, 102, 103, 104, 105, 106, 108 °F (within the heating limits of the model).
Order custom set by specifying "XXXXXX-__F" when ordering. (Part number followed by temperature in Farenheit.)

POINT-OF-USE TANKLESS ELECTRIC WATER HEATERS

Electro-mechanical models.

DHC Series				\$229.00
074050	DHC 3-1	120 v 3.0 kW, single phase	*	
074052	DHC 3-2	240 v 3.3 kW / 208 v 2.5 kW, single phase	*	
074053	DHC 4-2	240 v 3.8 kW / 208 v 2.9 kW, single phase	*	
074051	DHC 4-3	277 v 4.5 kW, single phase		
074054	DHC 5-2	240 v 4.8 kW / 208 v 3.6 kW, single phase		
074424	DHC 6-2	240 v 6.0 kW / 208 v 4.5 kW, single phase		
074055	DHC 8-2	240 v 7.2 kW / 208 v 5.4 kW, single phase		
232204	DHC 9-3	277 v 9.0 kW, single phase		
074056	DHC 10-2	240 v 9.6 kW / 208 v 7.2 kW, single phase		

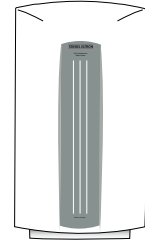

*Ships with 0.5 gpm aerator

WHOLE HOUSE OR MULTIPLE TAPS TANKLESS ELECTRIC WATER HEATERS

Thermostatic models, electronically controlled.

Adding a Stiebel Eltron TLC Assembly to a DHC-E will meet the requirements of UPC 413.1/ASSE 1070.
See TLC assemblies in Tankless Accessories.

DHC-E			
224201	DHC-E 8/10	240 v 7.2 kW / 208 v 5.4 kW, single phase 240 v 9.6 kW / 208 v 7.2 kW, single phase	\$319.00
		DHC-E 8/10 is two models in one! Unit is switchable to 7.2 kW or 9.6 kW during installation.	
230628	DHC-E 12	240 v / 208 v 12.0 kW, single phase	\$339.00

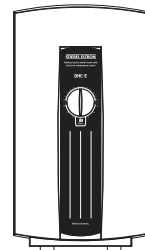

TANKLESS ELECTRIC GAS OR ELECTRIC TANK BOOSTER

Electronically controlled.

MegaBoost			
524201	MegaBoost	240 v 9.6 kW / 208 v 7.2 kW, single phase	\$389.00

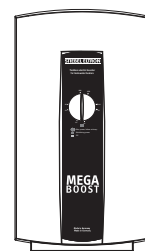

WHOLE HOUSE OR MULTIPLE TAPS TANKLESS ELECTRIC WATER HEATERS

Electronically controlled.

Tempra® Plus models are equipped with a digital temperature display and Stiebel Eltron's exclusive Advanced Flow Control™. Tempra® B models have neither feature.

Tempra® Plus and Tempra®

223420	Tempra® 12 B	240 v 12.0 kW, single phase	\$564.00
224196	Tempra® 12 Plus	240 v 12.0 kW, single phase	\$679.00
223421	Tempra® 15 B	240 v 14.4 kW, single phase	\$744.00
224197	Tempra® 15 Plus	240 v 14.4 kW, single phase	\$879.00
223422	Tempra® 20 B	240 v 19.2 kW, single phase	\$784.00
224198	Tempra® 20 Plus	240 v 19.2 kW, single phase	\$919.00
223424	Tempra® 24 B	240 v 24.0 kW, single phase	\$824.00
224199	Tempra® 24 Plus	240 v 24.0 kW, single phase	\$959.00
232885	Tempra® 29 B	240 v 28.8 kW, single phase	\$864.00
223425	Tempra® 29 Plus	240 v 28.8 kW, single phase	\$999.00
232886	Tempra® 36 B	240 v 36.0 kW, single phase	\$924.00
223426	Tempra® 36 Plus	240 v 36.0 kW, single phase	\$1059.00

Tempra models wired to 208 v single phase will output 75% of the 240 v rating.

29/29 Plus & 36/36 Plus may be wired for balanced 3-phase 208 v.

15/15 Plus, 20/20 Plus, 24/24 Plus may be wired for unbalanced 3-phase 208 v.

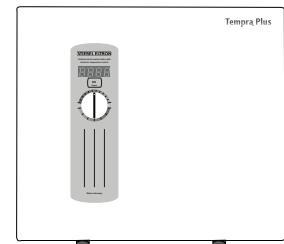

Tempra® Plus Series
12–36 kW

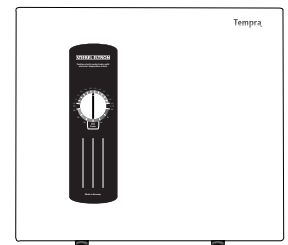

Tempra® B Series
12–36 kW

POINT-OF-USE MINI-TANK WATER HEATERS

With T&P valve, cord with plug.

SHC Mini-tank

233219	SHC 2.5	2.5 gal., 120 v, 1.3 kW, single phase	\$219.00
234046	SHC 4	4 gal., 120 v, 1.3 kW, single phase	\$269.00
235089	SHC 6	6 gal., 120 v, 1.3 kW, single phase	\$319.00

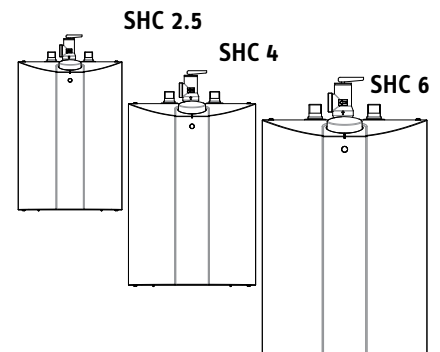

HEAT PUMP WATER HEATER

True heat pump water heater.

233058	Accelera® 220 E	240 v 58 gal., 2.15 kW max power input	\$2,999.00
233059	Accelera® 300 E	240 v 80 gal., 2.15 kW max power input	\$3,199.00

Accelera®
220 E

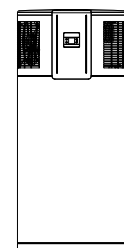

Accelera®
300 E

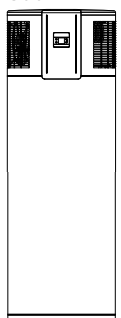

DOMESTIC HOT WATER STORAGE TANKS

For solar thermal, geothermal, or indirectly-fired applications.

224110	SB 300 E 79 gal., single coil, integral resistance element	\$2099.00
234111	SB 400 E 106 gal., single coil, integral resistance element	\$2499.00
221222	SBB 400 S 109 gal., single coil	\$2199.00
187873	SBB 300 Plus 81 gal., dual coil	\$2299.00
187874	SBB 400 Plus 109 gal., dual coil	\$2499.00
187875	SBB 600 Plus 163 gal., dual coil	\$3499.00



TANKLESS ELECTRIC WATER HEATER ACCESSORIES

502346	Mini™-E TLC Assembly UPC 413.1 compliant temperature limiting control for Mini™-E, completely assembled, includes ASSE 1070 mixing valve	\$290.00
581012	DHC-E TLC Assembly UPC 413.1 compliant temperature limiting control for DHC-E, completely assembled, includes ASSE 1070 mixing valve	\$290.00
550457	ASSE 1070 Mixing Valve for Mini™-E 3/8" comp. mixing valve alone for Mini™-E	\$99.00
550455	ASSE 1070 Mixing Valve for DHC-E 1/2" mixing valve alone for DHC-E	\$99.00
540444	Lead-free Brass Isolation Valve Kit Cold inlet & hot outlet isolation valves, pressure relief valve	\$139.00

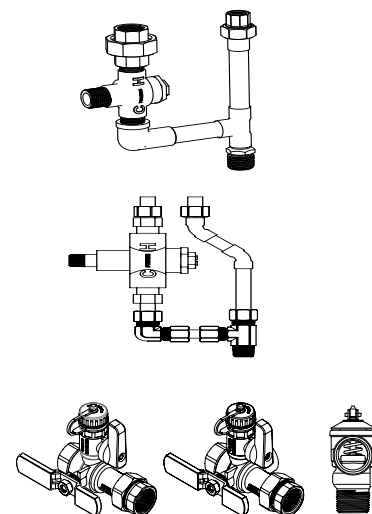

TANKLESS ELECTRIC WATER HEATER ACCESSORIES

540000	Flow-aid Tankless Descaling Kit	\$275.00
	3.5 Gal. bucket, 350 GPH pump, 2 5' rubber hoses, 1 qt. fluid	
540002	Flow-aid Fluid Refill	\$39.00
	1 quart	
692442	Scale TAC-ler	\$489.00
	6 GPM water conditioner for scale prevention, includes 1 cartridge	
692443	Replacement Scale TAC-ler Cartridge	\$289.00
	Cartridges have approximate 2-year life	



TOUCHLESS AUTOMATIC HAND DRYERS

Ultra-quiet.

Galaxy™	Alpine white ABS plastic housing		\$225.00
073009	Galaxy™ 1	120 v, 1.85 kW, single phase	
073010	Galaxy™ 2	240 v / 208 v, 2.0 kW, single phase	
Galaxy™ M	Aluminum alloy housing with alpine white powder coat finish		\$295.00
073724	Galaxy™ M 1	120 v, 1.85 kW, single phase	
073725	Galaxy™ M 2	240 v / 208 v, 2.0 kW, single phase	
Galaxy™ M	Aluminum alloy housing with metallic finish		\$315.00
073724-___	Galaxy™ M 1	120 v, 1.85 kW, single phase	
073725-___	Galaxy™ M 2	240 v / 208 v, 2.0 kW, single phase	

Insert **S** for Silver Metallic or **G** for Charcoal Gray Metallic

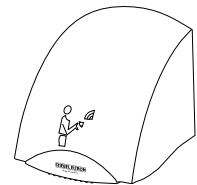
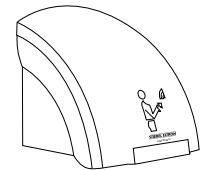

High speed.

Ultronic™	Aluminum alloy housing with alpine white powder coat finish		\$299.00
231585	Ultronic™ 1 W	120 v, 0.985 kW, single phase	
231587	Ultronic™ 2 W	240 v / 208 v, 1.0 kW, single phase	
Ultronic™	Aluminum alloy housing with stainless steel metallic finish		\$459.00
231584	Ultronic™ 1 S	120 v, 0.985 kW, single phase	
231586	Ultronic™ 2 S	240 v / 208 v, 1.0 kW, single phase	

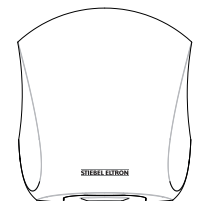

ELECTRIC SPACE HEATERS

Surface mounted.

CK Trend fan heater \$149.00

236304	CK 150-1 Trend	120 v, 1.5 kW, single phase
236305	CK 200-2 Trend	240 v / 208 v, 2.0 kW, single phase

CK fan heater \$185.00

074058	CK 15E	120 v, 1.5 kW, single phase
074057	CK 20E	240 v / 208 v, 2.0 kW, single phase

CKT fan heater with timer \$205.00

230345	CKT 15E	120 v, 1.5 kW, single phase
230346	CKT 20E	240 v / 208 v, 2.0 kW, single phase

CNS-E convection heater

231542	CNS 50-2 E	240 v / 208 v, 0.5 kW, single phase	\$149.00
232068	CNS 75-2 E	240 v / 208 v, 0.75 kW, single phase	\$164.00
231543	CNS 100-2 E	240 v / 208 v, 1.0 kW, single phase	\$174.00
231544	CNS 150-2 E	240 v / 208 v, 1.5 kW, single phase	\$199.00
231545	CNS 200-2 E	240 v / 208 v, 2.0 kW, single phase	\$224.00
231546	CNS 240-2 E	240 v / 208 v, 2.4 kW, single phase	\$249.00
233586	CNS 100-1 E	120 v, 1.0 kW, single phase	\$174.00
233587	CNS 150-1 E	120 v, 1.5 kW, single phase	\$199.00

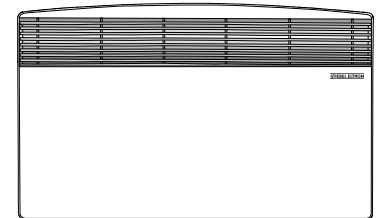
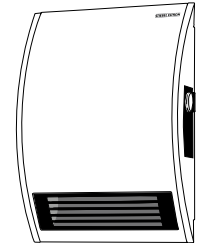
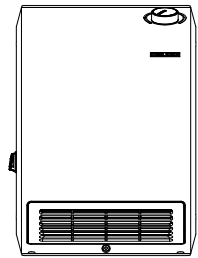

SHORT-WAVE INFRARED ELECTRIC RADIANT HEATERS

SunWarmth™ radiant heater

234047	CIR 150-1 I	120 v, 1.5 kW, indoor use, supplied with cord with plug	\$249.00
234048	CIR 150-1 O	120 v, 1.5 kW, indoor/outdoor use, supplied with cord with plug	\$299.00
234049	CIR 200-2 O	240 v, 2.0 kW, indoor/outdoor use, Hard wired, supplied with cord	\$339.00
234050	CIR 400-2 O	240 v, 2.4 kW, indoor/outdoor use, Hard wired, supplied with cord	\$619.00

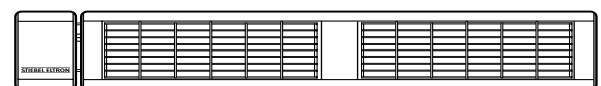

Products can be mixed in one order to get to a lower price bracket, or to get prepaid shipping. A \$75.00 crating charge applies to SBB 300 and SBB 400 tanks only. There is no crating charge for the Accelera®, SB-E tanks, or the SBB 600 tank. The Accelera®, SB-E tanks, and SBB tanks are always FOB West Hatfield.